

KARI

POWER CONNECTOR

PKL 9-25



SIMPLIFIES MAINTENANCE

When taking the pump in for maintenance it is easy to disconnect the PKL 9-25. Just loosen the screw in the middle and the female and male connector can be separated. Then the caps should be mounted in their places to prevent any dirt or water entering the connector.

MOUNTING

Mounting of the PKL 9-25 is easy and fast. It is also possible to mount the PKL 9-25 afterwards to the pump cable. If the assembling is done carefully (all screws and nuts tightened properly) the connector is watertight.

SAVE

When the PKL 9-25 is used, there is no need for an electrician when the pump is disconnected, which saves costs. Also the gastight cable bushings in the pumping station remain in proper condition since there is no need to open them. The pump will always rotate in the right direction after reconnection, which saves worry and time.

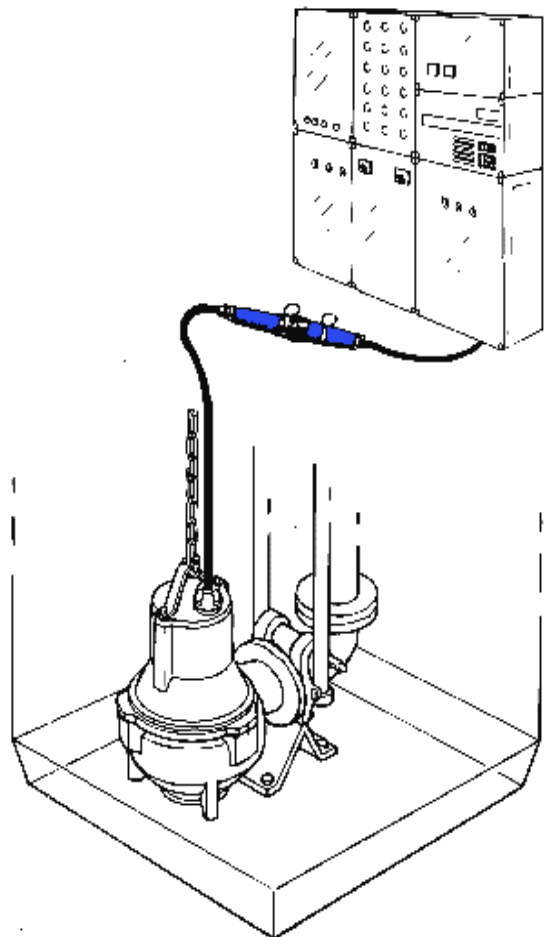

KARI-FINN OY

Sireenintie 24, 15230 Lahti, Finland
Tel. +358 3 876 810, Fax. +358 3 784 1332

Internet: <http://www.kari-finn.fi>

E-mail: kari-finn@kari-finn.fi



PKL 9-25 TECHNICAL DATA

Voltage	750 V AC
Current	8 x 25 A+
Max. pump power in Y/D starting	22kW
Tightness	IP 67, watertight
Temperature range	-40... +40 C
Length	400 mm
Max. diameter	85 mm
Weight	1,45 kg

TYPE MARKING E.G.

PKL 9-25-S2
 PKL = power connector for pumps
 9 = 9 poles
 25 = each core rated 25 A
 Cable bushing sizes
 = S0: 9-16 mm, S1: 12-18 mm
 S2: 18-25 mm, S3: 22-32 mm
 Available number of poles
 = 4 - 10

NOTE:
 Cable bushings are not interchangeable.

NOTE!

PKL 9-25 is completely watertight when the parts of the connector are pushed right to the bottom. Tighten the screw clamp in the middle and the cable bushing screws thoroughly. The length of a properly assembled connector is 315mm.



Connections of the PKL 9-25

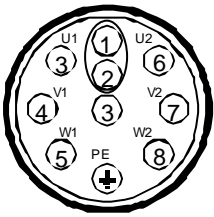

Female socket
 Shall be mounted to the cable which comes from the starter (power outlet). Plug viewed from inside, i.e. from direction of cable.

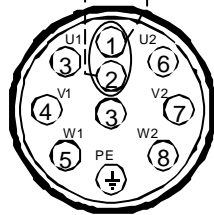
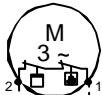

Male plug
 Shall be mounted to the cable which leads to the pump. Plug viewed from inside, i.e. from direction of cable.

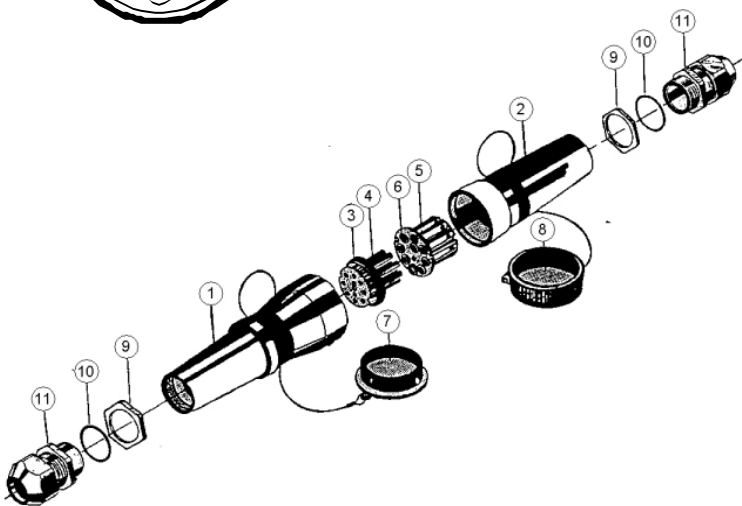

Part no.	Description	
1	Connector body	male
2	Connector body	female
3	Plug body	male
4	Connecting pins	1+8
5	Socket body	female
6	Connecting sockets	1+8
7	Cover	male
8	Cover	female
9	Nut 12-18 or 18-25	
10	O-ring 12-18 or 18-25	
11	Cable entrance bushing 12-18 or 18-25	